

# 府營中神田住宅敷地実測平面圖

縮尺參百分之壹  
單位 米

昭和參拾七年五月測量

八尾市庄ノ内二一二

本州測量株式會社

測量士望月弥太郎

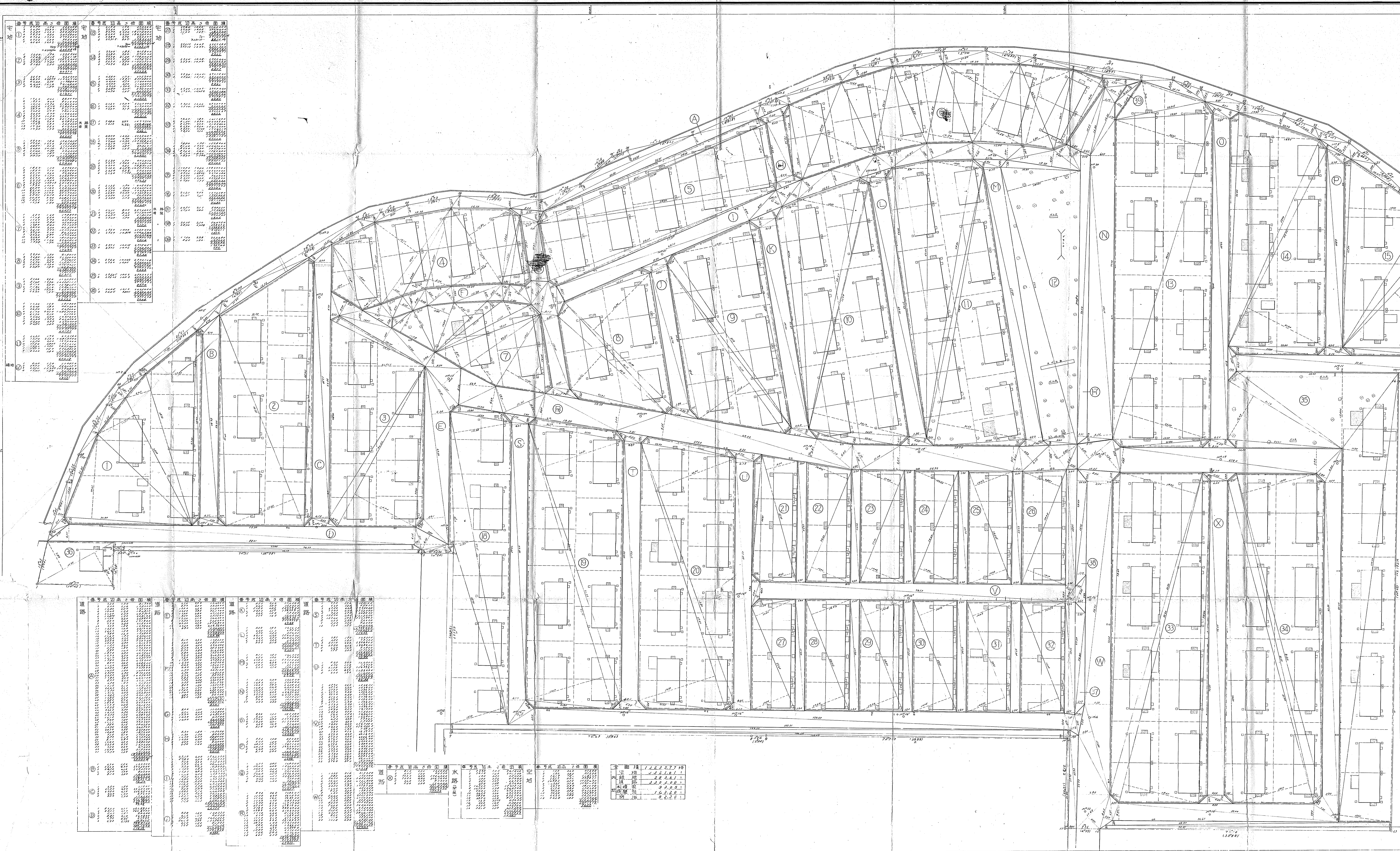
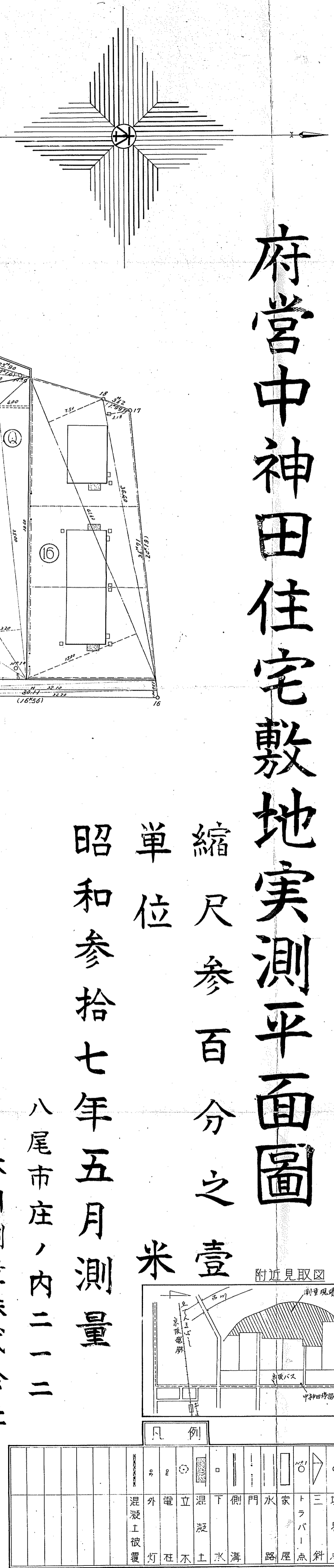

Table with 3 columns and multiple rows of numerical data, likely representing survey measurements or lot specifications.

Table with 3 columns and multiple rows of numerical data, likely representing survey measurements or lot specifications.

Table with 2 columns and multiple rows of numerical data, likely representing survey measurements or lot specifications.

Table with 2 columns and multiple rows of numerical data, likely representing survey measurements or lot specifications.

中神田